

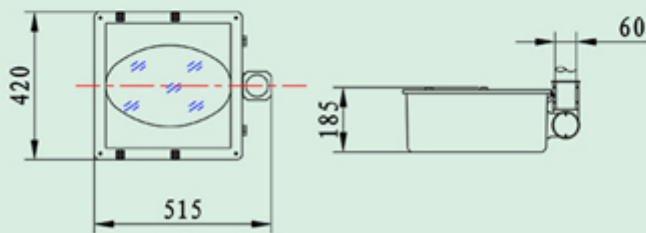

[Outdoor lights NEMDD-38](#)

Operating Voltage: 220-240V/50-60HZ Max Watt:  
HPS400W , MH400W Lamp:250-400W/E40 Material:Die  
casting Aluminum(Body) Glass  
protection(Diffuser) IP Rating: IP65  
Installation tube size:  $\varnothing$ 60mm  
Packing:720x340x220 mm

**NEMDD-20**



[Outdoor lighting NEMDD-20](#)

Operating Voltage: 220-240V/50-60HZ Max Watt:  
HPS400W , MH400W Lamp:250-400W/E40/E27  
Material:Die casting Aluminum(Body) Glass  
protection(Diffuser) IP Rating: IP65  
Installation tube size:  $\varnothing$ 60mm Angle adjustable  
from 0-90degree Packing:540x460x235 mm



[Outdoor lightings NEMDD-30](#)

Operating Voltage: 220-240V/50-60HZ Max Watt:  
HPS400W ,MH400W Lamp:150-400W/E40 Material:Die  
casting Aluminum(Body) Glass  
protection(Diffuser) IP Rating: IP65  
Installation tube size: ø60mm Packing:  
940x415x320 mm



[Road lighting NEMDD-35](#)

Operating Voltage: 220-240V/50-60HZ Max Watt:  
HPS250W ,MH250W Lamp:150-250W/E40 Material:Die  
casting Aluminum(Body) Glass  
protection(Diffuser) IP Rating: IP65  
Installation tube size: ø48/60mm Packing: 680 x  
300 x 195 mm



[Road lightings NEMDD-36](#)

Operating Voltage: 220-240V/50-60HZ Ma x Watt:  
HPS150W ,MH150W Lamp:70-150W/E27 Material:Die  
casting Aluminum(Body) Glass  
protection(Diffuser) IP Rating: IP65  
Installation tube size: ø48mm Packing: 540 x 460  
x 235mm/2pcs mm



#### [Road lamp NEMDD-60A](#)

Operating Voltage:220-240V/50-60HZ Max Watt:  
HPS400W ,MH400W(37A) HPS250W, MH250W (37B)  
Lamp:150-400W/E40 (37A) 70-250W/E40 (37B)  
Material:Die casting Aluminum and sand-casting(Body) Glass protection(Diffuser) IP  
Rating: IP65 Installation tube size:  $\varnothing$ 60mm(37A)  
 $\varnothing$ 60mm(37B) Packing:850 x 370 x 270 mm(37A)  
660x280x180mm (37B)



#### [Road lamp NEMDD-60 B](#)

Operating Voltage:220-240V/50-60HZ Max Watt:  
HPS400W ,MH400W(37A) HPS250W, MH250W (37B)  
Lamp:150-400W/E40 (37A) 70-250W/E40 (37B)  
Material:Die casting Aluminum and sand-casting(Body) Glass protection(Diffuser) IP  
Rating: IP65 Installation tube size:  $\varnothing$ 60mm(37A)  
 $\varnothing$ 60mm(37B) Packing:850 x 370 x 270 mm(37A)  
660x280x180mm (37B)



#### [Road lamps NEMDD-40](#)

Operating Voltage: 220-240V/50-60HZ Max Watt:  
HPS400W ,MH400W Lamp:150-400W/E40 Material:Die  
casting Aluminum(Body) Glass  
protection(Diffuser) IP Rating: IP65  
Installation tube size:  $\varnothing$ 60mm Packing: 1175 x  
420 x 310 mm Structural feature: 1.Housing cast  
by 900T die-cast machine,featuring high  
strength,compact structure and smooth profile.  
2.Reflector is made of high purity aluminum  
plate e x tension-  
formed. 3.Top-lift cover for  
easy repair and maintenance. 4.Internal bulb-  
replacement structure for e x cellent water-and  
dust-proof property . 5.Highly-transparent

toughened glass shade.



[Road light NEMDD-50](#)

Operating Voltage: 220-240V/50-60HZ Max Watt: HPS400W , MH400W Lamp:250-400W/E40 Material:Die casting Aluminum(Body) Glass protection(Diffuser) IP Rating: IP65 Installation tube size: ø60mm Packing: 1205x415x355 mm

[Led street light](#), [Street lights](#), [street lighting suppliers](#), [street light bulbs](#), [antique street lamps](#), [antique street lights](#), [street light fixture](#), [street light post](#), [led street light](#), [new street lighting](#), [street lighting](#), [street lamp](#), [City street lights](#), [city street lighting](#), [city street lights](#), [Commercial street lights](#), [Street Lighting Design](#), [commercial street lighting](#), [Road lights](#), [road lamp](#), [road street lamp](#), [road safety light](#), [road traffic lights](#), [road bike light](#), [2 light road](#), [Sidewalk lights](#), [green street stop lights](#), [sidewalk lighting](#), [solar sidewalk light](#), [Solar street lights](#), [solar street lamps](#), [solar street lighting](#), [Highway lights](#), [Outdoor lighting](#), [Light poles](#), [pole light](#), [street light poles](#), [outdoor light poles](#), [pole lights](#), [electrical pole](#), [outdoor lamp post](#), [cast iron lamp poles](#), [Cast Iron Lamp Posts](#), [city street lamp poles](#), [city street lamp posts](#), [Commercial street lamp poles](#), [Conical poles](#), [conical poles](#), [Decorative poles](#), [decorative flag pole](#), [decorative street light pole](#), [decorative pole lights](#), [Garden lamp poles](#), [garden lamp poles](#), [High mast](#), [high mast pole](#), [high mast light](#), [high mast lighting](#), [for high mast](#), [Middle poles](#), [poles in the middle](#), [pole in middle](#), [middle school pole](#), [Octagonal poles](#), [Sidewalk lamp poles](#), [Solar street lamp poles](#), [Stainless steel poles](#), [Steel tube](#), [Street lamp poles](#), [Street light poles](#), [Street lighting poles](#), [road light poles](#), [Galvanized poles](#), [Painted poles](#), [Pole accessory](#), [Garden lights](#), [malibu garden lights](#), [low voltage garden lights](#), [indoor garden lights](#), [garden lights uk](#), [12 volt garden lights](#), [Garden Lamps](#), [solar power garden lights](#), [Classical garden lights](#), [garden rock lights](#), [Garden path lights](#), [garden spot light](#), [Garden wall lights](#), [garden wall lighting](#), [Outdoor garden lights](#), [outdoor garden lamps](#), [Solar garden lights](#), [solar powered garden lighting](#), [Garden Decorative lights](#), [Floodlights](#), [Flood lights](#), [outdoor flood lights](#), [solar flood lights](#), [fluorescent flood lights](#), [spot flood lights](#), [halogen flood lights](#), [fluorescent flood light](#), [Bulkhead floodlights](#), [Floodlighting Fittings](#), [Military Lamps](#), [Flood lamps](#), [Searchlight Lamps](#), [Reflector Lamps](#), [Mini floodlights](#), [Small Space Floodlights](#), [Portable floodlights](#), [Outdoor Lamps](#), [Quartz halogen floodlights](#), [Military Lamps](#), [Head Lamps](#), [400W flood lamps](#), [1000W flood lamps](#), [2000W flood lamps](#),

Ningbo Nai'erming Lamps Co., Ltd.

Add: Xiaodong Industrial Zone, LanJiang Street , Yuyao City , Zhejiang Province China

Contact: shelly chai SALES MANAGER

Tel: 0574-62598616 13456109164

Fax: 574-62598616

E-mail: [sales@outdoorlightingn.com](mailto:sales@outdoorlightingn.com)

WebSite: <http://www.outdoorlightingn.com>